

Charleston, South Carolina  
Office of Register Mesne Conveyance

Plat recorded this 15 day of April, 1986, at 4:22 o'clock in Plat Book 68, Page 117, and tracing cloth copy filed in File 2, Drawer 3, Folder 42, Drawing No. 15. Original plat (with print) delivered to Fiddlers Cove Assoc.

*Robert M. King*

Register Mesne Conveyance

SOUTH CAROLINA COASTAL COUNCIL CRITICAL LINE

MARSH

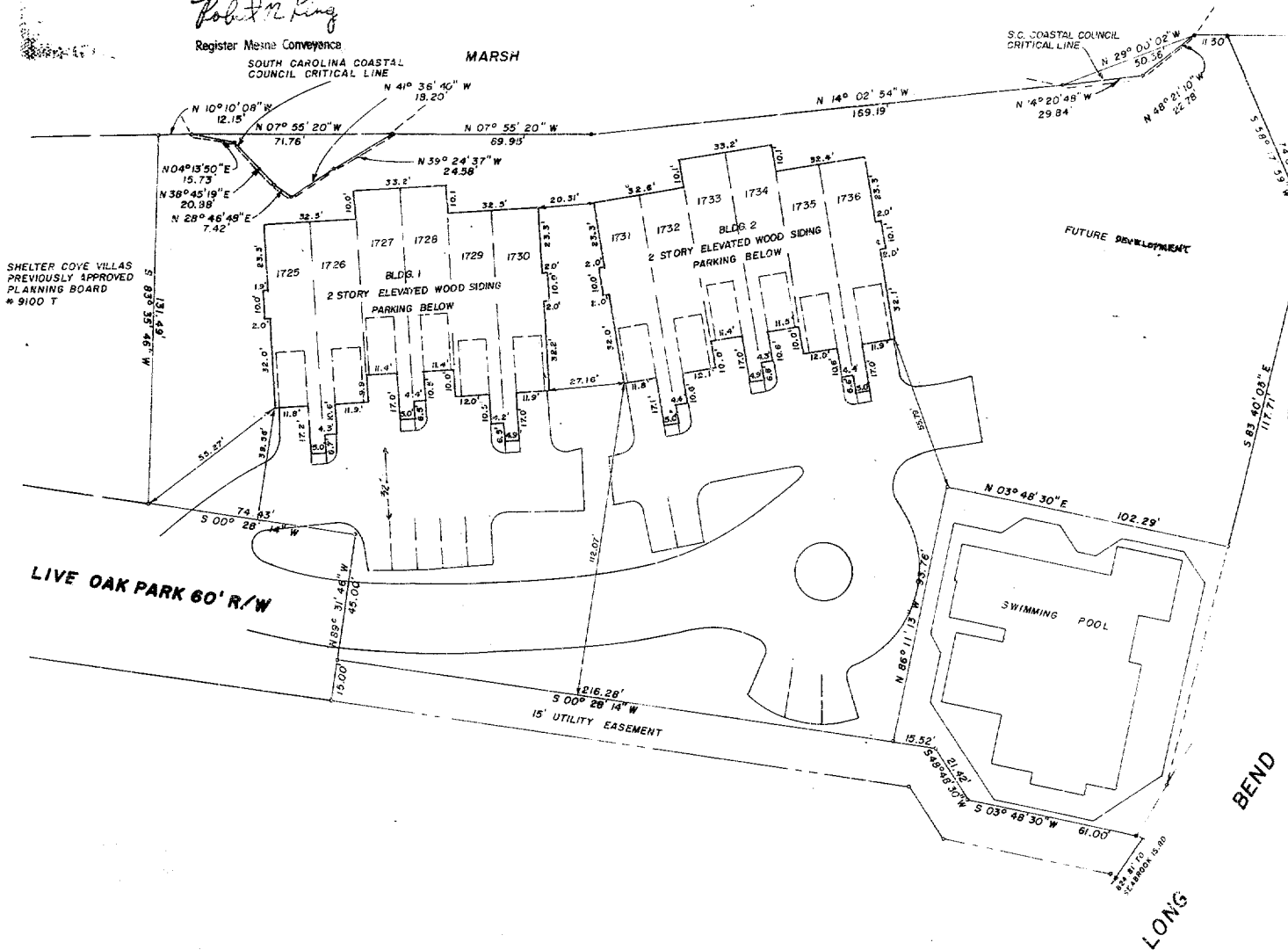
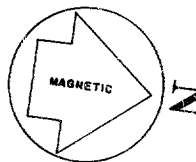

# SEABROOK ISLAND

## CHARLESTON COUNTY, S.C.

FINAL SURVEY FIDDLERS COVE

APPROVED PLAT

13 2

*E. M. Seabrook, Jr.*

DIRECTOR OF PLANNING  
CHARLESTON COUNTY PLANNING BOARD

APR 15 1986  
DATE

SCALE: 1" = 30'

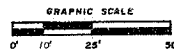

APRIL 14, 1986

I, E. M. SEABROOK, JR., a Registered Surveyor of the State of South Carolina hereby certify that I have surveyed the property shown hereon, that this plat shows the true dimensions of the property that all necessary markers have been installed and the precision is 1/7500.

*E. M. Seabrook, Jr.*  
E. M. SEABROOK, JR.  
CIVIL ENGINEER & LAND SURVEYOR  
S.C. REG. NO. 1375



E. M. SEABROOK, JR., INC.  
ENGINEERS - SURVEYORS - PLANNERS

- NOTES:
1. THERE ARE 6 PARKING SPACES BELOW EACH BUILDING (12 TOTAL). 22 SPACES PROVIDED - 9' x 18' MIN.
  2. OWNED BY FIDDLERS COVE ASSOC.
  3. AREA 1.62 ACRES
  4. 12 UNITS TOTAL
  5. T.M.S. 149-1-D-12
  6. BLDG. 1 CONTAINS TWO 2 B.R. UNITS (1486 SQ. FT. EACH) & FOUR 3 B.R. UNITS (1732 SQ. FT. EACH). BLDG. 2 CONTAINS TWO 2 B.R. UNITS (1486 SQ. FT. EACH) & FOUR 3 B.R. UNITS (1732 SQ. FT. EACH).
  7. THE S.C. COASTAL COUNCIL CRITICAL LINE HAS BEEN ESTABLISHED AS OF FEB. 1984 & IS SUBJECT TO CHANGE OVER A PERIOD OF YEARS.